

2nd NOVEMBER 1960

VOL. 131

NUMBER 3386

THE ORIGINAL
'DO-IT-YOURSELF'
MAGAZINE

HOBBIES *weekly*

FOR ALL
HOME CRAFTSMEN

FREE
plan

SAMMY SEAL

Also in this issue:

BUILD A MODEL
VILLAGE

COLLECTORS' CLUB

CACTI GARDENS
FOR CHRISTMAS

ADDING COLOURS
TO SLIDES

GARDENING JOBS
FOR NOVEMBER

SHIP MODELLING
AND NOVELTIES

ETC. ETC.

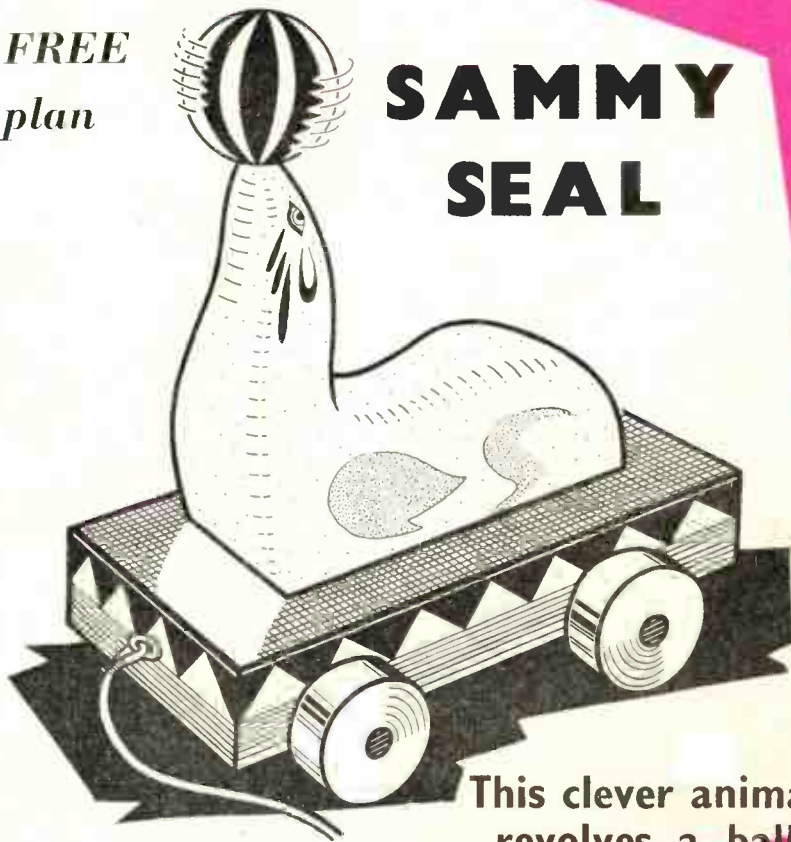

**This clever animal
revolves a ball**



Up-to-the-minute ideas

Practical designs

Pleasing and profitable things to make

World Radio History

5^p

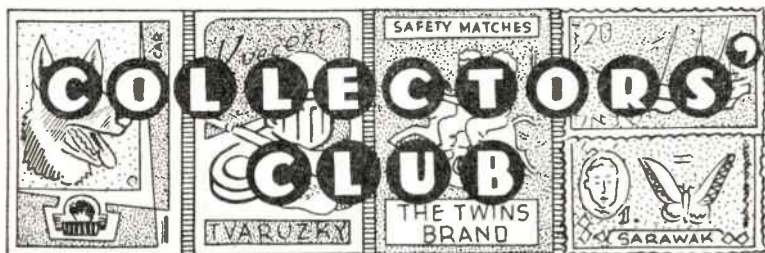

PLAIN, everyday soap may be all right for some boys and girls, but not Joanne Higginbotham. She has been collecting soap images for over five years, and now has on display at her home in America fifty-four interesting pieces.

She began her collection when she visited California and some images in a shop window caught her eye. She has added many charming characters to her collection since then. Especially at Christmas and birthdays do her friends and relatives aid her in gathering new pieces.

Favourites include a pair of Dutch shoes, a humorously carved drunk, and a Kewpie doll. Other pieces are a mother hen and two chicks, an elephant, a bear, three tiny ducks, a lion, camel, monkey, two rabbits, some characters from 'Gulliver's Travels', a fish, Santa Claus on skis, a pair of black and white Scotties, and a dog in a kennel. In spite of exercising caution in handling, and imploring her friends to do the same, some of the images do become chipped. This has happened to her replicas of the Seven Dwarfs, so that they had to go the way of all soap. No doubt the damage all came out in the wash!

MISSE G. BEARDWELL of 186 Whalebone Lane South, Dagenham, Essex, writes: 'I would like to get in touch with a pen-



Miss E. G. Beardwell

friend, either sex, aged about 30 years. My hobbies include stamp collecting, visiting zoos, old churches, museums, and historical places, also reading, etc.'

REQUESTS FOR MORE FRIENDS

Vernon E. White, F.R.G.S., is starting a collection of brewery labels. 'The jam makers have very attractive labels, and it is my intention to collect these as well', he says. 'I am a land surveyor. My son collects stamps. We would like to exchange items of interest with other readers throughout the world.' Write to 19 Lancaster Street, Coorparoo, Brisbane, Queensland, Australia.

We get hundreds of pen friend letters. Here's a list of addresses to choose from:

Miss Jean Beer, 84 St. Aidan's Road, East Dulwich, London, S.E.22. Aged 16. Hobbies include stamps, cheese labels, and letter writing.

David Harrison, 40 Shawbridge Street, Clitheroe, Lancashire. Stamps, match labels.

P. Tickner, 32 Brent Way, Wembley, Middlesex. Age 16. Fishing, scouting, camping.

Lawrence Bush, 12 Agnes Road, Northampton. Age 15. Stamps, beer mats, records.

Colin H. Stewart, 544 Rutherglen Road, Glasgow, C.5. Age 20. Photography, beer labels, coins.

L. O. Fisher, 6969 N. Figueroa Street, Los Angeles 42, Calif., U.S. Stamps, postcards.

ALLAN CALVERT writes: 'Since I last wrote to you I have received over 900 beer labels from England, Canada, South Africa, India, Holland, and Ceylon.'

Allan would like pen friends throughout the world. You can write to him at 33 Locksley Park, Finaghy, Belfast, 10.

'I have been a reader of *Hobbies Weekly* for over three years, and have seen no other magazine to beat it', says Clive Astley of 108 Buxton Lane, Caterham, Surrey.



Hungary has issued an attractive set of match labels commemorating the Olympic Games, including the above.

'I would like pen friends in Australia, New Zealand, and Ceylon. My hobbies are photography and geography.'

If you still need friends, choose them from the following:

S. Goodyer, The Wingrove, Keynsham, Nr. Bristol. Age 12. Hobbies include stamps, labels, cards, etc.

Vytis Vabalas, S. Neris Street, 28B Kaunas Centr, Lithuania, U.S.S.R. Collects: match labels, unused stamps, playing cards. Languages: Russian, English, German, French.

Frank G. Myers, 718 Union Avenue, Los Angeles 17, California, U.S.A. Collects: match labels, hotel labels, stamps, postcards. Languages: English, Italian, French, German, Portuguese.

Walter M. Loeb, M.D., 4568 E. Mercer Way, Mercer Island, Washington, U.S.A. Collects: paper money of the world.

Vadim Shchelkunov, Ul. Prof. Popova 41/5 KV, 63, Leningrad P. 137, U.S.S.R. Collects: match labels, stamps. Languages: English, French, German.



CACTUS gardens if properly planted can be attractive decorations. The containers for the gardens can often be improvised from such things as posy rings and plastic shaving bowls. However, with a little extra trouble, attractive concrete troughs can be constructed to measure.

To do this, a strip of thin aluminium sheet about 18 in. long and $2\frac{1}{2}$ in. wide should be obtained. This is bent to an oval shape, or circular if a round bowl is required, and the ends fastened together by means of a piece of thin wire passing through holes in the ends of the strip. The metal ring so formed must be covered with paper on the outside to prevent the concrete from sticking. This will be found to be quite easily done by folding the paper over the top and bottom, and, if necessary fastening with Sellotape.

The prepared ring is stood on a sheet of paper on a piece of glass, and the rough shape pencilled on the paper. The concrete mixture should then be made up from one part cement, one part soft sand, and two parts sharp sand. It must be thoroughly mixed and sufficient water added to produce a stiff paste. Some is then spread on to the paper on the glass to fill the marked shape, and levelled to approximately $\frac{1}{4}$ in. thick. The mould is then stood on to this base, and, using the fingers (rubber gloves may be worn) pieces of the mixture are taken up and plastered on to the outside of the mould, working from the base to the top. If the

consistency is correct, the concrete will adhere readily, and should be about $\frac{1}{4}$ in. thick. Care should be taken to ensure that the pieces placed on to the lower parts of the sides stick well to the base concrete. Finally a brush over with a paint brush dipped in water will finish off the job.

10—Gardens for Christmas Gifts

The prepared bowl should be allowed to remain undisturbed for three days, and then the wire fastening the aluminium strip can be cut, and the strip carefully removed. Any paper adhering can be washed off. If drainage holes are required they may be poked in the base with a pencil before the concrete has set, but generally speaking, for indoor bowl gardens, they are not necessary.

When preparing the container for planting, the first thing to do is to place a 1 in. layer of coarse gravel in the bottom (less for a very small one) for drainage. A mixture of sand and John Innes' No. 1 compost is then added. A little bone meal should be mixed into the compost to provide a slow acting fertilizer for the plants.

In choosing plants it is important to obtain dwarf or slow growing ones that will not swamp your container in a

matter of months. It is also important that the plants should have the same growing period. A pan of Lithops growing amongst pebbles of a similar colour is the most fascinating way of arranging these plants, but they should be grown on their own and not mixed up with cacti which have greater water requirements.

Assuming that the average person wants an attractive mixed bowl of plants and not a specialized collection of Lithops or any other genera, the following plants are excellent to start with: *Opuntia microdasys*, variety *minima*, *Rebutia minuscula*, *Frailea columbiana*, small *Echinopsis* off-sets, *Ceropegia woodsii*, small off-sets of *Aloe variegata*, cuttings of *Crassula lycopodioides*. However, there are lots of other plants that can be used, so if you have any off-sets or spare cuttings by all means try them out. *Ceropegia woodsii* is a trailing plant that can be used to grow over the edges of the container or over pieces of stone.

Once the plants are in place, the surface of the garden may be decorated by means of appropriately placed pieces of stone and pebbles. The surface may be top-dressed with sand or granite chip-pings if desired.

The completed garden should be gently watered and placed in a light position. If your container has no drainage hole it must always be watered carefully. Always make sure that it has dried out from previous waterings before moistening again. If there is a drainage hole the garden may be kept just moist in summer, but during the winter it should be kept much drier. If kept in a heated living room it may need a weekly watering during the winter to counteract the dry atmosphere.

Small gardens made up on the lines suggested, in good time, make excellent Christmas presents, far better than the pathetic and exorbitantly expensive efforts often seen in shops. (P.R.C.)



A plastic trough



A home-made concrete bowl

Build yourself a Village-(1)

SOME four miles from Eastbourne on the South Coast there is a small village named Polegate where the renowned Wannock Gardens are situated. These are ornamental gardens of interest to gardeners in general for there are tropical fruits in the hothouses, walks with trained fruit trees, ornamental shrubs, a wishing well, and an attractive novelty in the form of a miniature village.

Our photograph shows part of this village, which has many interesting and humorous features. At the little cafe we see such notices as 'Try our Dear Little Teas' or 'You won't be fed up here' while a foreman in charge of some



The miniature village at Wannock Gardens

By H. Mann

workmen is asleep in a bed. There are humorous notices on tombstones in the village churchyard where 'A Vicar with Sober Habits is required' and many, many other features which make this village so interesting. There is a row of shops in the village square, a church, a castle, a windmill, a village lock-up and even a few merry-go-rounds which revolve on the turn of a handle.

The entire miniature village is built in a corner of the gardens and miniature shrubs are used for trees, and although you may not be able to build such a village in your own garden this idea can be the basis of a fascinating hobby of building your own village from matchboxes on a piece of hardboard. The building may go on indefinitely and you will start a fascinating project in which your family or friends can join. This will be realised when we come to the more detailed instructions about building.

First of all we require some kind of plan for the layout of our village and we can do no better than start with a map. This will be needed throughout the building stages and will be required for reference. In Fig. 1 we suggest a plan for a small village of this kind and you will see that we have provided for a street, square with a row of shops and other features. This is only a suggestion and you may be able to produce a much better scheme for your own village or adapt one from a large scale ordnance survey map. Whatever method you follow it is best to make a note of what features you desire, inserting them on the

map before embarking on the building programme. Moreover, we may incorporate a river, duckpond, or even a railway line, but it will be appreciated that having embarked on a set plan it is impossible to make drastic alterations when the building has progressed.

Another factor we have to consider is the advantage of a lay-out which bears a gentle slope up towards the back. This makes the rear buildings stand a little higher and they may be seen to better advantage than on a flat lay-out which is uninteresting. Here again your incline must be planned in advance.

A further reference to the photograph

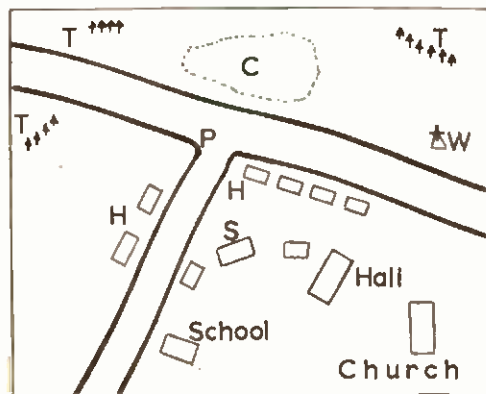

FIG 1

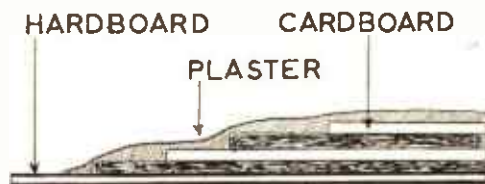

FIG 2

Key to map:—

- C - Castle
- H - Houses
- P - Signpost
- S - Shops
- T - Trees
- W - Windmill

may help you to decide what features should be incorporated in the village and provision must be made for all types of inhabitants. We must remember a school for the children, the church, houses, shops, a cafe, perhaps a castle or windmill, while you may include some unusual feature in the form of stocks or market cross, at your discretion.

Let us now return to our map in Fig. 1

and study this a little more closely. The road from the base can be made to rise on a slight gradient towards the castle on the top of the hill and this will make the whole so much more realistic. Then we have the shopping area in the centre and houses can be built around this, while the church can be made in a corner to itself.

Much depends on how large you wish to plan your project but we would suggest obtaining a piece of hardboard not less than 15 in. by 20 in. If your project is to be more ambitious the size may be greater or you may make a much smaller village if desired.

We have already mentioned the value of making the village rest on a sloping site and this is done by using layers of cardboard and odd scraps of hardboard.

Glue a piece of hardboard on to the centre of the base as shown in Fig. 2 and

where the shopping centre may be placed. Odd pieces of hardboard and cardboard of varying grades and each of smaller size can then be positioned and glued to make a gradient as shown. The whole is then covered with a plaster crack filler to make the foundations of the village. You may proceed similarly if you prepare your own plan but remember to leave those areas level where shops or houses are to be built.

It will be appreciated that the use of scraps of cardboard not only economises in the plaster filler but also makes the entire foundations much stronger. Apply the plaster from the bottom, working upwards, and smoothing over the joints while the plaster is still wet. It is as well to give a coating of filler to the entire base and ultimately it will be possible to scrape away the material in places where it is uneven and where a building site

may be involved. The coating of plaster should not be too thick yet it must not be so thin that it would crack, so endeavour to lay an even application about $\frac{1}{4}$ in. thick over the cardboard layers, smoothing out with a small piece of celluloid as you proceed.

When the surface has dried we must refer to the original map of the village for the next step. A real builder will first plan the roads on his site so we must do just the same, marking in the roads and any paths with a crayon. The roads must be made and you have the alternative of colouring with water colour or applying a 'tar macadam' surface. The latter can be made by painting the roadways with glue and then applying sand or sawdust. Any surplus will brush away when the glue dries, and then we can start erecting our buildings.

To be continued

The 'Shoe House' visits a Hospital

WE have often published stories in *Hobbies Weekly* of how readers have given pleasure to children in hospital by making them toys. Our picture illustrates how we at Hobbies also have the welfare of children at heart.

It all started with an exhibition in a London hotel, when models made from Hobbies kits and designs were on show.

Representatives from the national papers and leading magazines were there, and a centre of attraction was the Old Woman in the Shoe musical box, which is the subject of one of the free designs in *Hobbies 1961 Annual*.

The chef at the hotel was also obviously impressed with the novelty of this design, as he decided to make his own version of it — in cake form! There

it was, the shoe and the house, complete with details such as toadstools, doors and windows, and even the shoelaces. All in delicious cake covered with marzipan and icing in appropriate colours.

This, we thought, was too nice for grown-ups — so it was decided to send the cake to a children's hospital. Your editor had the pleasure of presenting it to the Jenny Lind Hospital, Norwich, where, after being admired by the staff and children, it was cut up for their enjoyment.

Kit No. 259 Spcl. for making the model — in wood, of course — includes all materials, and costs only 24/-. There is a choice of twenty-seven tunes which can be incorporated into the model, and these musical movements are 14/11 extra. The tune starts when the roof of the house is raised, and there are compartments inside for trinkets or cigarettes, etc.



Admiring glances from some of the young 'walking' patients before the cake was sampled
(Photo: Courtesy 'Eastern Evening News')

Next week 'Radio Mech' will describe how to make a 4-transistor amplifier. Also novelties and projects for all the family will be featured.

MAKE SURE OF YOUR COPY

ADD COLOUR TO SLIDES

THE colouring of black and white lantern slides with photo tints is quite a simple task. The photo tints are sold in boxes containing a number of small bottles of strong transparent colours, and these colours, diluted with water as required, are brushed onto the slides. The slides must be illuminated from below, and the box described in this article was constructed for that purpose.

It consists of a wooden box containing an electric light bulb at one end. At the other end is a mirror inclined at an angle of 45 degrees. The mirror throws a beam of light through a ground-glass screen, and then through the slide. The box provides a comfortable support for the hand holding the paint brush, and as the bulb is not directly under the slide, it does not dry the slide too quickly.

The box is made from $\frac{1}{2}$ in. wood. Plywood is satisfactory, although solid wood is superior but more expensive. The only tools required are a fretsaw, small drill, and glasspaper.

The base consists of a piece of $\frac{1}{4}$ in. wood 9 in. long by $6\frac{1}{2}$ in. wide. The sides are 9 in. by $3\frac{1}{2}$ in., and one side has a hole to accommodate the lamp socket. This hole is $1\frac{1}{4}$ in. in diameter, and is 2 in. from the end and $1\frac{1}{2}$ in. from the edge. The end pieces of the box are 6 in. by $3\frac{1}{2}$ in., and each has a ventilation slot, as shown in Fig. 1, measuring 4 in. by $\frac{1}{2}$ in.

The top of the box also consists of a piece of $\frac{1}{4}$ in. plywood, 9 in. by $6\frac{1}{2}$ in. At a distance of $\frac{1}{2}$ in. from one end, cut out a section 3 in. square, equidistant from either side. This is the aperture to allow the light to reach the slide, and is, of course, slightly less than the size of a $3\frac{1}{2}$ in. slide.

By
N. E.
Jenkinson



The finished illuminator, showing adaptor for 2×2 slides in the foreground.

The frame to hold the slide in position over the aperture is shown at A in Fig. 1. It consists of a 4 in. square of $\frac{1}{8}$ in. plywood. From the centre of this piece is cut a $3\frac{1}{2}$ in. square, leaving a narrow frame of wood $\frac{3}{8}$ in. wide. To facilitate the removal of the slide from the frame a space $\frac{1}{2}$ in. wide is cut from one of the sides. This enables the finger to lift the slide out of the frame. Secure the frame to the top of the box by means of four screws, thus leaving a rim $\frac{1}{2}$ in. wide to hold the slide over the aperture.

Now obtain a square of ground glass from any photographic dealer. It should be slightly larger than the aperture, say, 4 in. square. Secure it to the underside of the top of the box by means of a narrow wood frame. The top of the box is now finished, and merely requires holes for the fixing screws which secure it to the box.

Obtain a piece of mirror, 6 in. by $4\frac{1}{2}$ in. This is inclined at 45 degrees inside the box, and to hold it in position a strip of wood $\frac{1}{2}$ in. wide is secured to the bottom of the box, $3\frac{1}{2}$ in. from the end, as at B in Fig. 1.

The box is now ready for assembly. Insert a pearl bulb in the lampholder. A 40 watt bulb is ample, and anything of greater power will tend to dazzle the eyes. Fix the mirror in position, and screw the top of the box in place. Finally affix four rubber feet to the bottom of the box.

As constructed, the box is for use in painting the $3\frac{1}{2}$ in. slides, but it can, of course, be used for the smaller $2\frac{1}{2}$ in., and 2 in. slides. To adapt it for use with the smaller slides it is easy to construct a wooden frame to drop into the aperture, and one for use with the 2 in. square slides is shown in Fig. 2. It consists of a piece of wood $3\frac{1}{2}$ in. square containing an aperture $1\frac{1}{2}$ in. square, and a thin frame to hold the slide in place.

With a little practice it is relatively easy to colour the $3\frac{1}{2}$ in. slides, and a surprising amount of the details can be added with a fine brush. The smaller slides are more difficult, and it is usually possible to colour only the broad outlines such as hills, sky, etc. However, the effect on the screen is well worth the trouble.

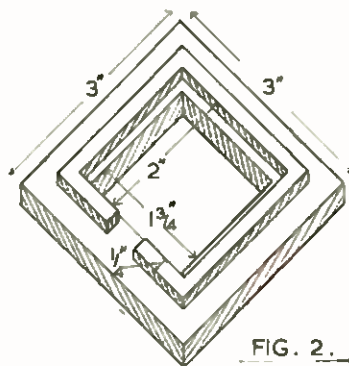
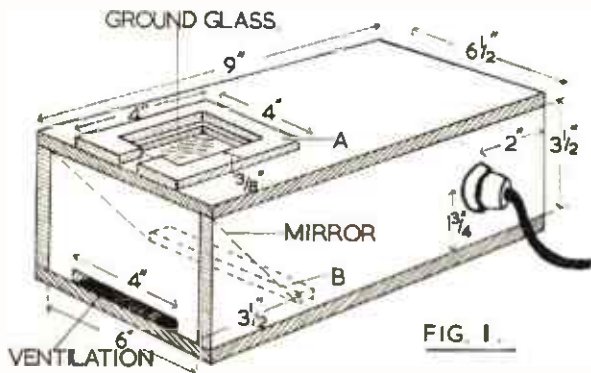

Illustrated on front

MAKING SAMMY THE SEAL

WHEN visiting a circus, children are always thrilled by the antics of the performing seals, and even parents are amazed at the dexterity with which these animals are able to balance a revolving ball on their noses.

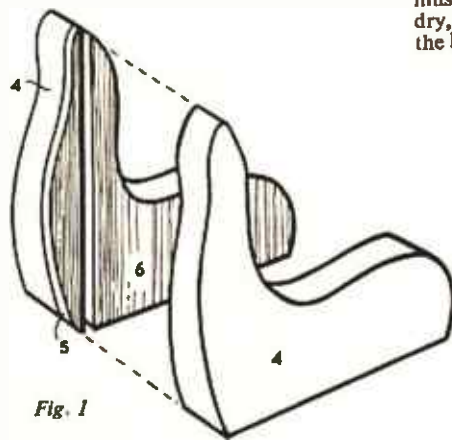

Fig. 1

Such a performing seal is featured in our design which makes up into a delightful model, and would look its best in gaily painted colours. As the toy is pulled along by the child, the ball revolves realistically on the nose of the seal. This action is obtained from the movement of the front wheels, a disc on the axle transferring the drive vertically by means of a dowel rod on which is fixed the ball.

All parts for making the toy are shown full size on the design sheet. They should be traced and transferred by means of carbon paper to their appropriate thicknesses of wood, and cut out neatly with a fretsaw. Be particularly careful to make neat circles when cutting out the holes, such as in the sides for the axles. Clean up all parts thoroughly with glasspaper.

Commence assembly of the toy with the body of the trolley. This consists of piece 1, two pieces 2, and two pieces 3, which are glued together as shown on the design sheet. Next make up the seal, consisting of two pieces 4, between which are sandwiched pieces 5 and 6 so as to form a channel to take the $\frac{1}{4}$ in. dowel (piece 7). Fig. 1 clearly shows how the parts are assembled to form the seal and the channel. Allow the glue to dry thoroughly and then round off the edges of the animal to give a good shape, an idea of which can be gained from Fig. 2.

Now glue the seal in position on the trolley, ensuring that the channel exactly coincides with the position of the hole in piece 1.

At this stage the seal and platform should be painted in appropriately gay colours to outlines as suggested in the finished illustration. When the paint is dry, push the rear axle (piece 9) through the holes provided in the sides (pieces 2),

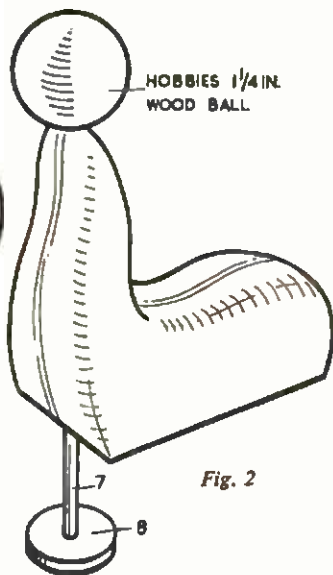

Fig. 2

and glue the wheels (pieces 11) on to the ends.

Drill a $\frac{1}{4}$ in. hole to a depth of $\frac{1}{2}$ in. in a Hobbies $1\frac{1}{2}$ in. diameter wood ball, which can now be painted in a striped

Hobbies Kit No. 3386 for making "Sam" the Performing Seal contains all wood, round rod, ball, etc., and costs 4/11. Kits from branches or from Hobbies Ltd, Dereham, Norfolk. (post 1/6 extra).

design, and glue the vertical shaft (piece 7) in the hole. Drop this down the channel in the seal and at the bottom end of the dowel rod glue on the disc (piece 8).

The makeup of the front axle is shown clearly on the design sheet. Glue on one wheel (11), insert the axle through the hole in the side, and slide on the driving disc (piece 12). Glue this in position as shown by the dotted lines on the design sheet. This disc should be located on the axle so as to engage satisfactorily with disc 8, and thus rotate the ball quite freely. These adjustments should be made at this stage and care should be taken to ensure that the discs engage satisfactorily. Finally, glue the other wheel on the end of the axle.

Paint the wheels, add a screw-eye to the front for pulling the toy along with a piece of string. Incidentally, it should be noted that graphite makes quite an effective lubrication to the dowel rod in its channel. This can be obtained by means of rubbing an ordinary lead pencil on the sides of the channel.

Towel Rail on Kitchen Drawer

IS your wife always asking you to fix her up with an additional towel rail in the kitchen, and you find that there isn't any wall space available? If so, then it is most probable that you will have a kitchen table with a drawer. Remove the drawer handle, and replace with a towel rail. This will serve the dual purpose of towel rail and drawer handle. (F.K.)

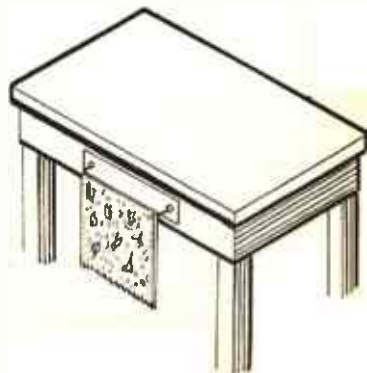

Proving that Metal Expands

WE all know that metal expands when heated. Otherwise, why would they have small gaps between lengths of railway track? But can you prove it? This little gadget, quickly made, will prove it to your most sceptical friend. . . .

By E. Capper

Obtain two wooden boxes of equal dimensions, and lay them on the bench about 10 in. apart. Find a length of flat iron bar that will bridge the two boxes.

Place a weight over one bar end - a brick will do. Now, take a steel knitting needle, and at right angles to one end, solder on a length of thin wire. Now place the knitting needle under the free end of the bar.

Make a graduated scale on the box side immediately behind the thin wire. Now, set a bunsen burner going, and stand it under the centre of the flat iron bar. As the bar becomes heated you will see the indicator wire move on the scale.

What happens is that the iron bar

cannot move at the end where it is held by the weight, so it expands at the other end only. As it does, so it pushes the knitting needle, which in turn rolls and moves the indicator wire attached to it.

The movement is, of course, very slight at its source, but is exaggerated by the length of the indicator arm. It is, you will find, quite a conclusive experiment.

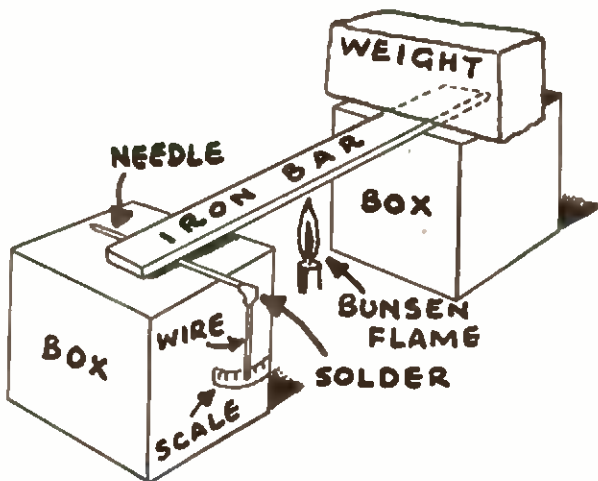

TRINKET BOX KIT No. 3070

Materials and instructions for making this 5½ in. long box cost

4/9 (postage 1/- extra)

HOBBIES LTD (Dept. 992),
DEREHAM, NORFOLK.

HEAR ALL CONTINENTS With H.A.C. Short-Wave Receivers

Suppliers for over 18 years of radio S-W Receivers of quality.

One-Valve Kit, Price 25/- Two-Valve Kit, Price 50/-

Improved designs with Denco coils. All kits complete with all components, accessories and full instructions. Before ordering, call and inspect a demonstration receiver, or send stamped addressed envelope for descriptive catalogue.

'H.A.C.' Short-Wave Products (Dept. 27) 11 Old Bond Street London, W.1

'LOG CABIN' CLOCK

Kit No. 3018

This Kit contains design with instructions, panels of selected wood and a reliable 30-hour movement, 27/-, plus 2/- postage.



HOBBIES LTD (Dept. 992) DEREHAM, NORFOLK

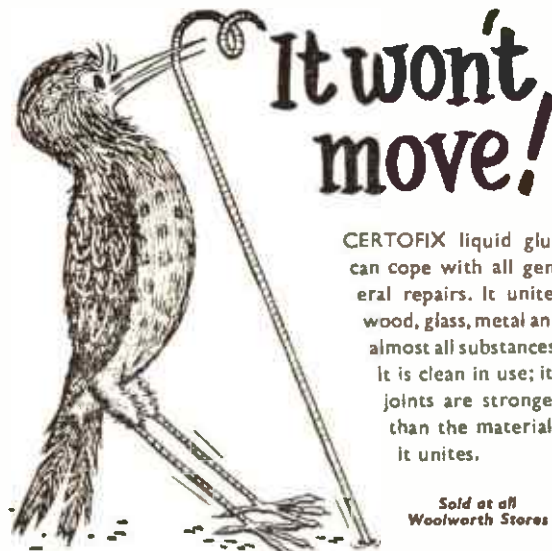

CERTOFIX liquid glue can cope with all general repairs. It unites wood, glass, metal and almost all substances. It is clean in use; its joints are stronger than the materials it unites.

Sold at all
Woolworth Stores

CERTOFIX

WILL Really FIX IT!



THESE NOTES REFER CHIEFLY TO MIDLAND GARDENS — DUE ALLOWANCE SHOULD BE MADE FOR CHANGE OF LATITUDE.

PLEASE to remember, the 5th of November, gunpowder, treason, and plot, and please remember, too, that this is a golden opportunity for getting rid of the accumulation of rubbish from the greenhouse and shed.

Prunings, old cabbage stalks, diseased plants, dead leaves from the rose beds, and anything burnable will add to the size of the bonfire. Later the ash may be spread on the plot reserved for next year's crop of potatoes to provide an additional source of potash.

Outside

TRY to fork over the borders where spring bulbs are planted. If you do it this month you will not damage the new growth. If you leave this work until after Christmas you will find that tulips and daffodils have made considerable progress, and many bulbs will be damaged. Soil that has not been limed for several years can be dressed after digging.

Set out plants of pansies, sweet-williams, Canterbury bells. Set tulip bulbs any time before the end of the month. Roses and other hardy shrubs can be planted from now until March, provided the soil is not frostbound.

ROCK GARDEN — Dead leaves cause decay, and many choice alpine are lost from damping off through this cause. Remove dead leaves and flowers, and put ashes over tender crowns to protect from frost during the winter. Continue to bait for slugs and snails.

FRUIT GARDEN — Prune orchard trees, and make new plantings where required. Currants, gooseberries, etc. should be set in well-drained and well-manured soil. Good preparation of soil pays dividends later on.

VEGETABLE GARDEN — Cut down asparagus, clean up bed, and mulch with

well-decayed manure. Dig when weather is suitable. Give leeks and celery the final earthing up. Protect celery with straw during frosty weather. Examine onions in store, and remove any that are decayed.

Inside — warm house and cool house

DO not be tempted to give too much heat yet. Keep the house dry and well ventilated. Bulbs required for early flowering should be brought into the warm house. Keep seedlings of annuals as near to the glass as possible.

Cold house

THERE is little to do this month except to keep clean and well ventilated. Lettuces need as much air as possible, but should be kept dry. Keep ventilators open except during frosty nights. Chrysanthemums which have bloomed should be cut down to about 9 in., and removed to cold frames. (M.h)

A TELEPHONE UNIT IN CONTEMPORARY STYLE

WITH this streamlined unit there will be no more fumbling for pencil and pad to take down that urgent phone message. You simply write it straight on to the built-in blackboard. What could be simpler?

Designed with clean lines, the unit can be made for less than £1, and it will grace the hall of the most modern of open-plan houses.

The two uprights are 1 in. planed deal or oak, topped with two wooden balls, painted red. These can be obtained from Hobbies (1 in. diam.) at 2d. each, plus 3d. postage.

The blackboard is a suitable sized rectangle of hardboard or three-ply wood, nailed across the uprights with panel pins. It is enclosed in a framing of 1/2 in. by 1/2 in. stripwood, also obtainable from Hobbies at 8d. per 3 ft. length, plus 1/6 postage. Special blackboard paint can also be obtained from Hobbies (1/3, plus 9d. postage). On no account

use ordinary paint; the chalk will just slide over the surface.

The matching wing sides are made from 1/2 in. plywood, as are the two shelves. The wings are glued and screwed to the sides of the uprights, whilst the shelves are held by screwing through from the outside of the wing pieces. Do remember to fill in any screwhead cavities with wood filler.

Note that rebates are cut at the back corners of the shelves to allow them to fit around the uprights.

The unit should be screwed to the wall through the two uprights. If you would prefer to conceal these screw heads, leave out the fitting of the blackboard until last, and fit it over the screw heads holding the unit to the wall.

Such a unit looks best painted really gay in a contrasty colour to the main scheme of the hall. Have a shallow tray on the top shelf to carry the chalk.

(E.C.)

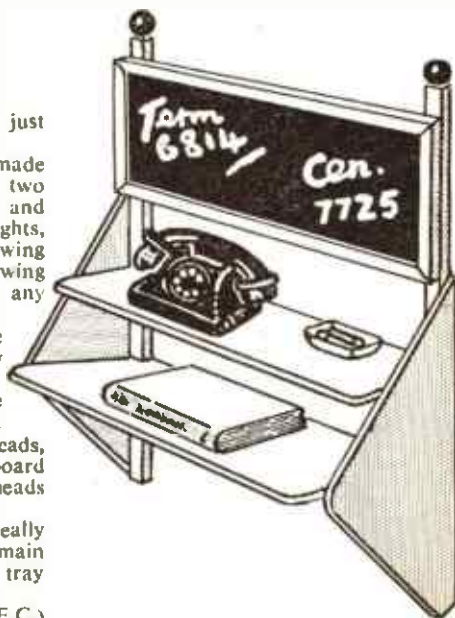

A Power-Driven Whirligig

THIS little toy is simple to make, and will amuse a child for hours.

First, take a cotton-reel, and part way into the central hole force-fit a length of dowelling. With a razor blade (do use care), cut a slot across the top of the dowelling, and insert into it a length of stiff card as a vane.

Now trim down another short length of dowelling so that it is an easy, revolving fit into the lower part of the hole in the cotton reel. This is the axle, and it should be fitted into a length of wood or baseboard.

Now, fit three hooks in the baseboard at the positions shown. The top hook should hold an elastic band. To the elastic band tie a length of strong thread, loop it around the cotton reel, as shown, and bring the free end through the remaining two hooks.

A pull on the thread will send the vanes revolving backwards and forwards. If the vanes are painted in multi-coloured stripes, it will give the effect of a spiral, rising and falling.

You can, of course, experiment with

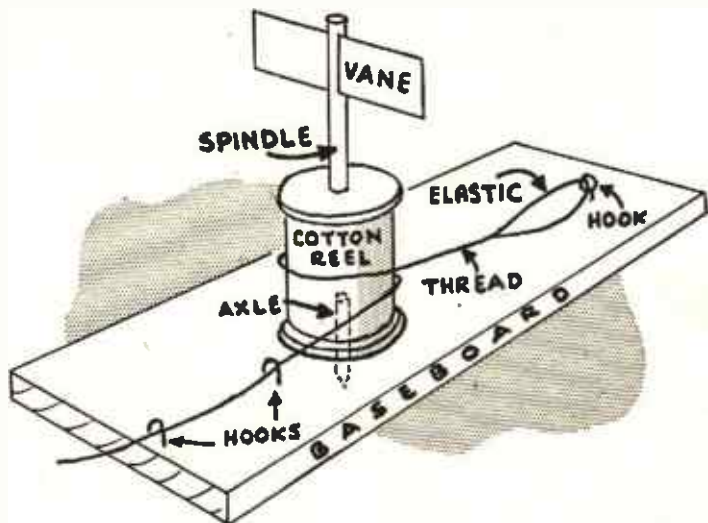

different tops to the spindle, instead of vanes. A gaily-painted circular piece of

card, held with a drawing pin, gives a colourful effect. (E.C.)

SINCE ancient times magicians have possessed the power of locating the whereabouts of concealed objects. . . . In such a manner you may choose to introduce a startling 'experiment' in the art of divination. Your simple apparatus will consist of four matchbox trays, a pencil, and a wooden draughtsman. The trays will be used as covers neatly numbered from one to four.

The effect is possible because you have previously glued a dark, lady's hair upon the bottom of the draughtsman. Thus, when you wished to 'divine' the hidden counter, you merely looked for the hair which protruded from beneath one of the covers and, later, you made the pencil dip in the proper place. Naturally, you must select a hair which is longer than the matchbox trays, and the trick must be performed upon a rough, dark

Protect your Pets' Drinking Water

THE water for pets may be safely put outside without fear of spilling if this simple wire spike is made. Tilt the container to remove for cleaning. (M.h.)

DIVINATION OF A DRAUGHTSMAN

Next, you instruct a spectator to hide the wooden counter beneath one of the covers whilst you turn your back. When this has been done you take up a pencil, grasp it between finger and thumb, and proceed to 'test' each cover. Explain to your audience that the pencil is being used as a divining rod, like the hazel twig used by water douers. Hold the pencil over each box in turn. Suddenly the rod is seen to dip and tap audibly against the cover which conceals the draughtsman. The experiment may be repeated.

coloured table cloth or carpet. Under these conditions your sharp eyes will always be able to see where the draughtsman is concealed, and it is unlikely that your subterfuge will be detected.

Fake telepathy may also be employed to locate the hidden counter. As soon as you have spotted the hair, immediately stare blankly into space, and ask your spectators to think deeply of the number on the cover beneath which the draughtsman is placed. After a suitable pause you name the number. (A.E.W.)

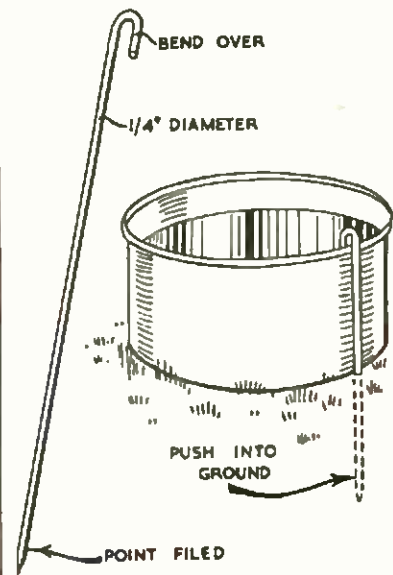
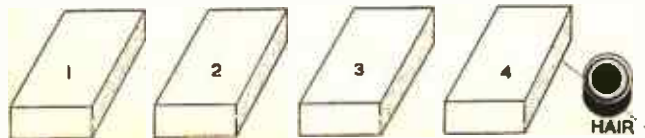



"build modern!"

WITH REAL BRICKS AND MORTAR

What exciting up-to-date building you can do with Contemporary Brickplayer! Models are architect designed to '0' gauge scale. Included are bricks in all required shapes, roofing, windows, doors; plans and instruction booklet. For re-use of bricks, dismantle by soaking in water.

CONTEMPORARY BRICKPLAYER KITS

'A'—19/11; 'B'—27/6; 'C'—50/-

TRADITIONAL BRICKPLAYER KITS

Kit 3—27/6; Kit 3A—27/6; Kit 4—52/-;
Farm Kit—63/-

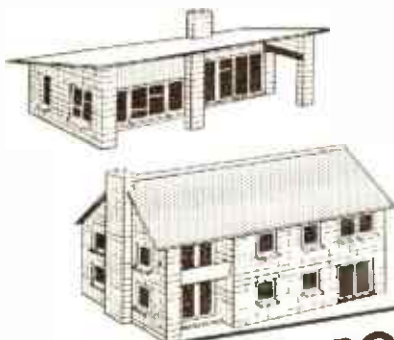

CONTEMPORARY

BRICKPLAYER

WIN A PRIZE! £21.0.0 £10.10.0 £5.5.0
also consolation prizes
are offered in the **BRICKPLAYER** contest

At good toyshops, hobby shops, department stores. Leaflet on request, together with name and address of nearest stockist if required.

J. W. SPEAR & SONS LTD. (Dept.H.W.), ENFIELD, MIDDLESEX

Mainly for Modellers

IN place of the usual method of gluing and tying shrouds in place at the top of the mast, here is a way that is both neat, secure, and more authentic in appearance.

Using a piece of rod or dowel of suitable size in relation to your mast, twist a figure 8 loop in fine wire. I use strands of copper wire from discarded electric flex. Slip one loop over the mast head, and attach the starboard shrouds to it. A similar figure 8 is then added for the port shrouds. This gives a firm and neat fastening for the shrouds on any of our sailing ship models.

Dead-eyes for miniature models

Very often when making a small scale model the question of dead-eyes, gives the beginner trouble. Commercial dead-eyes are usually too large, and without a small lathe, the making and drilling of small scale items can be very tedious, so much so that it may put off the aspiring ship modeller. Here is a method that, while taking some patience, is not beyond the powers of any beginner, and, indeed, can be used by the more experienced modeller with advantage.

The only tools needed are a small leather punch, No. 2, a razor blade or stencil knife, and a needle for boring lanyard holes. Materials needed are fine fuse wire, and No's. 2 and 4 Bristol Board.

On a piece of No. 2 B.B., glue discs of No. 4 B.B. that have been punched out with your leather punch. Cut out from No. 2 when the glue has set, and trim around the edge of the No. 4 discs, sufficient to allow you to glue around the piece of fuse wire to form the chain plates. Finish by gluing another disc of No. 2 on top of each No. 4 disc. This may seem a little complicated, but it is surprising how simple it becomes with a little practice.

Duplicate carvings

In models like Hobbies 'Royal Prince', etc, a number of carvings may be required, which are all alike. For example the circular port wreaths on the model mentioned. Apart from the time taken to carve a number of these, unless one is very expert the carvings will be sure to differ slightly.

The old method was to run glue around, and rough it up to represent carving. While giving quite a reasonable effect, it did not satisfy me as looking like authentic carving. Therefore, I

started using the following method.

A really good carving was made in hardwood to use as a master. Use a hard wood with smooth grain. Holly is excellent for the purpose. To make the mould, build a small box of plywood. For the wreaths it was 1½ in. square and ½ in. deep. Fill this with plaster of paris, coat the master with 3-in-1 oil, and press into the surface while soft. Leave until the plaster has set. On removing the master you will be left with a mould from which you can take a large number of impressions.

FITTINGS AND FINISHING

By 'Whipstaff'

Before each casting, coat the mould with oil to prevent sticking, and to enable you to remove castings from the mould without damage.

Castings can be made from plaster of paris, non-shrinking plastic wood, or even Barbola paste. I prefer the plastic wood as giving a stronger casting than the plaster. Figure-heads can be cast by forming in two halves, and gluing them together, while anchors, etc, may also be repeated in this way.

Weathered effect on sails

In earlier articles I have described methods of shading parchment sails to give the effect of the weather stains and colouring. But for some years now I have discontinued the use of parchment for this purpose. All my models, both when made from a Hobbies plan or plans drawn by myself or authentic ship draughts, are now fitted only with fabric sails. Apart from the fact that parchment sails always eventually break at the corners when the model is being cleaned, as they all must be, fabric sails besides being authentic, also enable us to secure and rig them correctly. Some of the detailed rigging I have given over the past years for our Hobbies models really need fabric sails if all details are to be added.

Before we shape the sails we must stain them to get the required weathered effect. This can be done by dipping in strong tea or coffee (no sugar or milk, of

course), and hanging up to dry. The surplus liquid will drain downwards, and give the heavy staining necessary in the lower corners.

To get the sails to retain the billowed shape I have found a way that gives me better results than older methods. This is to secure the sail over a curved block of wood, and give one or two coats of Britfix Sanding Filler, according to the texture of the fabric being used. This has the advantage that it does not deteriorate like starch, nor make the material thicken up; it also enables you, where necessary, to paint on designs with very little chance of the paint running, and giving the blurred lines so often seen on fabric sails. I have painted on fabric so treated with water colours and artist's oil colours.

Painting a clear waterline

Most beginners and, indeed, many more experienced model makers often have difficulty in painting a straight line around a hull, whether this is a thin waterline or the meeting line in a two colour hull. The best method I have found is the use of cellulose masking tape now available in small rolls at most departmental stores and paint shops.

In a two colour hull, such as are most of our old time models, paint the lighter colour first, going slightly over the dividing line. The tape is then put on over the first colour *when dry*, and with its edge along the line where the two colours are to meet, the second colour is painted on. When the tape is stripped off, which it does quite cleanly, you will have the two colours meeting on a perfect line.

For fine waterlines two tapes must be put on, the space between being the width of the painted line required. The line is painted, overlapping the tape slightly, and when dry, the tape is stripped off, leaving a perfect waterline.

'The World of Model Railways'

IN this book the reader is led gradually from small beginnings along the way to track laying, signals, remote control, scenery and other problems connected with this exciting hobby. Model railways and real railways are compared side-by-side. The photographs are excellent, many being in full colour and showing Continental and American railroads as well as British. An excellent book for enthusiastic youngsters and all who have fallen under the 'spell'. Make a note of it for Christmas.

Published by Percival Marshall & Co. Ltd. 19-20 Noel Street, London, W.1. Price 12s. 6d.

If you want
sound
soldering



you've only



to say the word



Say FLUXITE and you show yourself to be someone who *knows* about soldering — knows that nothing *but* FLUXITE will give the selfsame high standard results, whatever the type of soldering job you're doing. It's the one flux that simplifies *all* soldering.

**FLUXITE
SIMPLIFIES
ALL
SOLDERING**



FLUXITE LTD., Bermondsey St., London, S.E.1

GMB6

**MANY
MODELS
from
ONE TIN!**



Pyruma, plastic and ready to use from its tin, can be fashioned into the widest variety of models imaginable. Buildings for your model railway set, houses, ship models, animals and figures, ashtrays and plaques — all of which when set or baked to stone-hardness can be finished in natural colours. Get the Pyruma Model Instruction book — see Coupon, and start making things like those shown below.

**SANKEY'S
PYRUMA
PLASTIC CEMENT**



Made by amateur modellers, this signal cabin and lighthouse show how with PYRUMA you can get the effects of tiles, wood, brickwork, chimney pots, concrete — and even the rocks of the sea. The book offered below tells you how. Pyruma is obtainable from your local Ironmonger, Hardware Store or Art Material dealer.

POST THIS BOOKLET COUPON TO-DAY

To J. H. SANKEY & SON, LTD (Dept. HW),
ILFORD, ESSEX

I enclose P.O. 6d. (not stamps) for a copy of Pyruma Modelling Instruction Booklet, post free to:

NAME _____

ADDRESS _____

(BLOCK LETTERS PLEASE)

BUYING OR SELLING?

Classified advertisements on this page are accepted at a cost of 6d. per word prepaid. Use of a Box No. is 1/- extra. Send P.O. with advertisement to *Hobbies Weekly*, Advert. Dept., Dereham, Norfolk. Rates for display advertising on application.

PROFIT AND PLEASURE is obtainable from WRITING (typewriter unnecessary) or ARTISTRY. Send for free fascinating bumper package 'PROFITABLE LEISURE'. — Writers' & Artists' Ring (HW), 5 Fdmund Street, Birmingham.

KUKLOS ANNUAL. Irdispensable cyclist handbook. Tours, resthouses, money-saving hints. 3/- post free. — Burrow, Publishers, 2 Imperial House, Cheltenham.

100 DIFFERENT stamps free! Request 1d. upwards discount approvals. — Bush, 53 Newlyn Way, Parkstone, Dorset.

WORKERS with sewing machines required for making cushion covers. Regular work guaranteed. Apply enclosing s.a.c., Dept. 28, Arnold Trading, 10 Shelley Road, Worthing, Sussex.

WHEELS (Hardwood and Rubber Tyred Metal), Cot, Pram, and Doll's House Fittings and Papers, Beads, Transfers, Prints and other accessories. Stamp for new lists. (Trade supplied.) New address — JOYDEN CO., 91 Peplins Way, Brookmans Park, Herts.

NEW!

LEARN RADIO & T/V SERVICING and ELECTRONICS

and how to make and build your own equipment — using an exciting new Practical apparatus course. Ideal for starting your own business or as a fascinating hobby.

FREE Brochure, without obligation, from
RADIOSTRUCTOR Dept. G.81
READING, BERKS
Britain's leading radio training organization

LEARN RADIO & ELECTRONICS the NEW Practical Way! Very latest system of experimenting with and building radio apparatus — 'as you learn'. FREE Brochure from: Dept. H.W.10, Radiostructor, 40 Russell Street, Reading, Berks.

50 **KFNVA** Stamps 3/-. 25 Malta 4/6, 25 Philippine 5/-. Stamp Magazines 1/-. monthly. Try our 7 day approvals. E. C. F. Townsend (H), 92 Tenby Road, Edgware, Middx.

TRANSISTORS, Germanium Crystals, Headphones, etc. Lists and diagrams free. Germanium Diodes with three crystal set Circuits 1/-. Postage 4d. P.R.S. (11), 33 Bourne Gardens, London, E.4.

MAKE ART PAY. Learn to Draw/Paint Flowers, Birds, etc. in Designs or Pictures for waiting manufacturers. Profitable. Remunerative. Even beginner's work can sell. Post-card brings free brochures. Clun Valley Features (H.W.), Clun, Salop.

125 STAMPS FREE to approval applicants. — Read, 19 Kelstern Close, Cinderhill, Nottingham.

BUILD YOUR OWN electric guitar in one hour. Full size, professional guitar, with built-in pick-up and controls. Complete in presentation box, 7 gns., plus 5/- carriage. — Musicland, 88 Broadway Bexleyheath, Kent.

STAMPS AND CHEESE LABELS on Approval. — Daniels, 66 St. John's Road, Romford, Essex.

MANCHESTER

DO YOU KNOW?

HOBBIES LTD. have a branch at
10 PICCADILLY

where the manager and staff are always willing to give you the benefit of their experience with any of your handicraft problems. Why not pay a visit?

NEW Angles

on OLD favourites

from these Books bulging with BRIGHT IDEAS

Any volume in this most interesting range of books, each dealing with a different aspect of gummed papercraft, will show you a wealth of ideas, the way to carry them out, and give hours of intense enjoyment.

Each is the key to an economical hobby that is rich in variety, ranging from the making of a charming picture to framing it delightfully — from three dimensional models to wall decorations, from paper sculpture to charming flower studies.

Other books by FREDERICK T. DAY

Coloured Paper Decoration	7/6
Coloured Papercraft for Schools ..	7/6
Coloured Papercraft for Infants' Schools ..	6/-
Lampshade and Parchment Craft ..	8/6
Decorative Flower and Leafmaking ..	8/6
Gummed Strip and Paper Modelling ..	7/6
Paper Sculpture for Schools	7/6

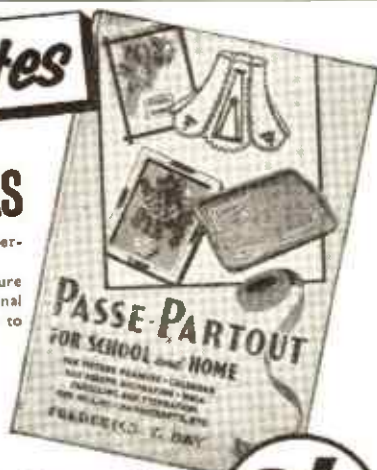

8/6



All books obtainable from:
Newnes & Pearson Ltd.
Tower House, Southampton St., Strand, W.C.1.
Ask your stationer to show you the Butterfly range of handicraft materials.

SAMUEL JONES & CO. LTD.

STATIONERY MILL, CAMBERWELL, LONDON, S.E.5. RODNEY: 5064

JACK-IN-THE-BOX

CUT two each of pieces A, B, and C from $\frac{1}{4}$ in. wood. Glue pieces B between pieces A, and use one piece C for the bottom and one for the lid. The lid will be hinged in place, and the bottom glued.

The head E and the washer D are cut from $\frac{1}{4}$ in. wood. Glue a piece of woolly material round the head to represent the hair. To make the spring, wind a piece of springy wire round a length of $\frac{1}{4}$ in. dowel and fix to the head and washer. The washer will, of course, be glued to the bottom of the box. Hold the lid in place with a hook and eye.

(M.P.)

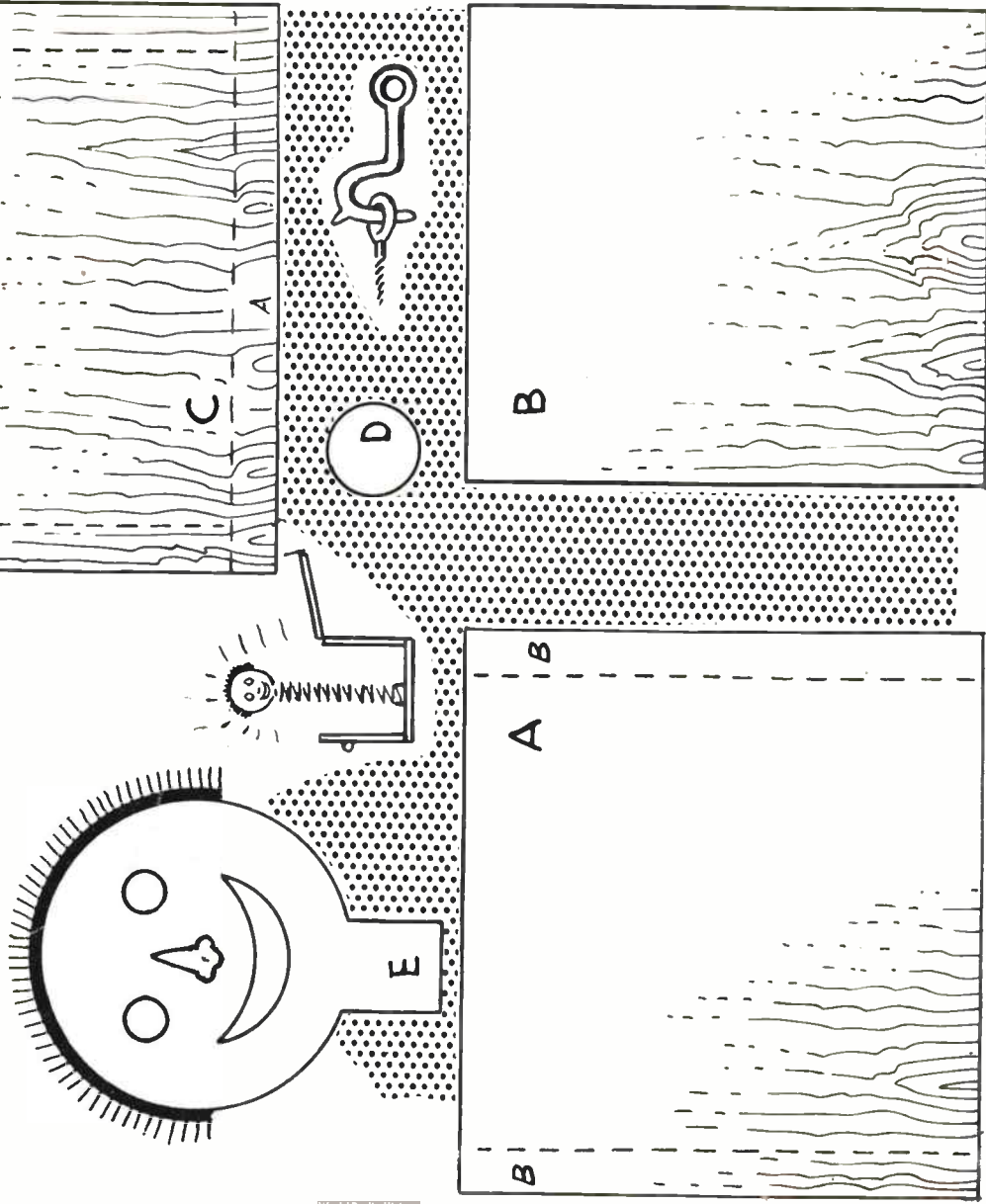

The new
— improved

TRIX

engineering CONSTRUCTION SETS



THREE GRAND PRESENTATION SETS

Set No. 1
With 48 components
and 13 blueprints.
Price: 16/7

Set No. 2
With 112 components
and 33 blueprints.
Price: 41/11

Set No. 3
With 231 components
and 48 blueprints.
Price: 66/11

TRIX TOOL ROLL

The illustrated engineer's style tool roll is made of strong plastic, has multiple inside pockets and a strong plastic tape on the outside for tying it when rolled. All components are exceptionally strong and precision-finished and their basic design permits them to be used again for new constructions.

TRIX BLUEPRINTS

Each set contains blueprints required for building the models specified in that set. Every detail of the construction is plainly visible and easy to follow and assembling is made easy by clear and concise descriptions and exact specification of components.

TRIX 'EXTRAPAK' UNITS

Each unit costs 2/- and contains in a transparent plastic bag an assortment of extra components for building new, different models when added to any of the three basic sets, already owned. 'Extrapak' units give an excellent opportunity for building up an imposing stock of components for bigger and better models. Each 'Extrapak' unit contains a list of components in the complete range of 24 packs.

TRIX 'PERMAG' ELECTRIC MOTOR

Some of the more intricate models can be run by electric power. The famous Trix 'Permag' Electric Motor 2051 has been designed to provide motive power for belt, chain or direct drive. It runs on a 4.8 volt dry battery and allows for efficient operating under the conditions of complete safety.

Ask your dealer or write direct to:

DUFAY(B'HAM)LTD., 308-310 SUMMER LANE, BIRMINGHAM 19